

12/11/98

ORIGINAL

RECEIVED
CLERK'S OFFICE

DEC 14 1998

STATE OF ILLINOIS
Pollution Control Board

STATE OF ILLINOIS
POLLUTION CONTROL BOARD
100 W. RANDOLPH STREET, SUITE 11-500
CHICAGO, ILLINOIS 60601

REQUEST FOR A REGULATED RECHARGE AREA

Stuart C. Nuss

) ~~PCB~~ R 99-19

Petitioner.

)
)
)
)
)

Members of the Board:

My request is that the Board consider the establishment of a **Regulated Recharge Area** in the area south of Durand, Il., as shown on the attached maps.

Annexation and zoning policies of the Village of Durand seem certain to cause damage to the aquifer supplying water to several homes neighboring the village, including my own.

The geology of our dolomite aquifer, with it's thin drift layer, is described by the Illinois State Geological Survey as having a high potential for contamination. Yet the Village plans to allow a potential secondary source (gas station) to be constructed at the peak of the hill where our aquifer is located, with no regard for our concerns of well contamination.

I feel that this aquifer should be protected for both the present and future use of all the residents. If you agree, please respond as soon as possible, so that we can stop this in the planning stages.

Thank you,
Stuart C. Nuss

Day Phone# 1-815-654-4005, 4030...(please leave a message)
Mailing address: P. O. Box 356, Durand, Il 61024

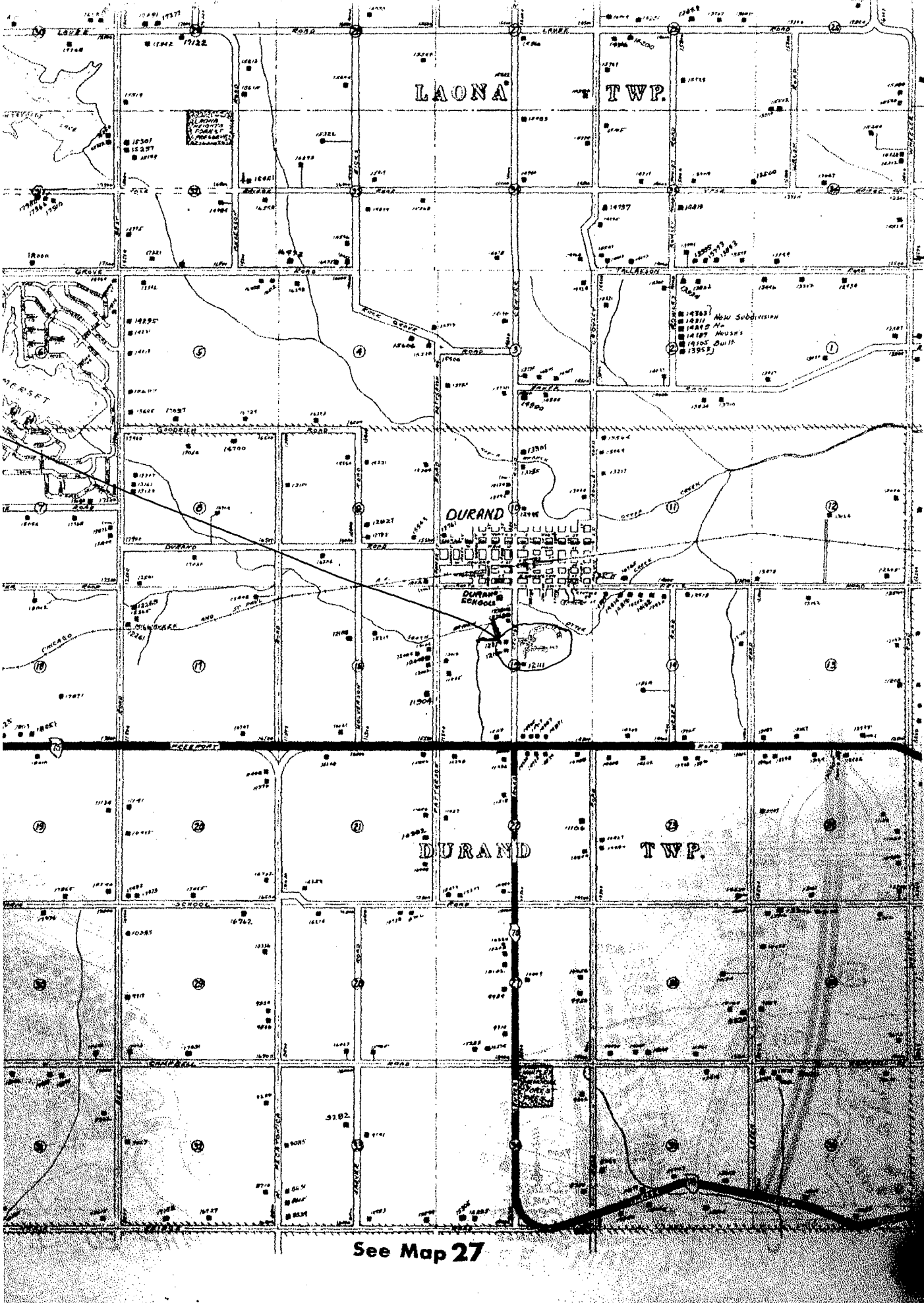

LAONA TWP.

DURAND

DURAND TWP.

New Subdivision
Mouses

DURAND SCHOOL

See Map 26

See Map 27

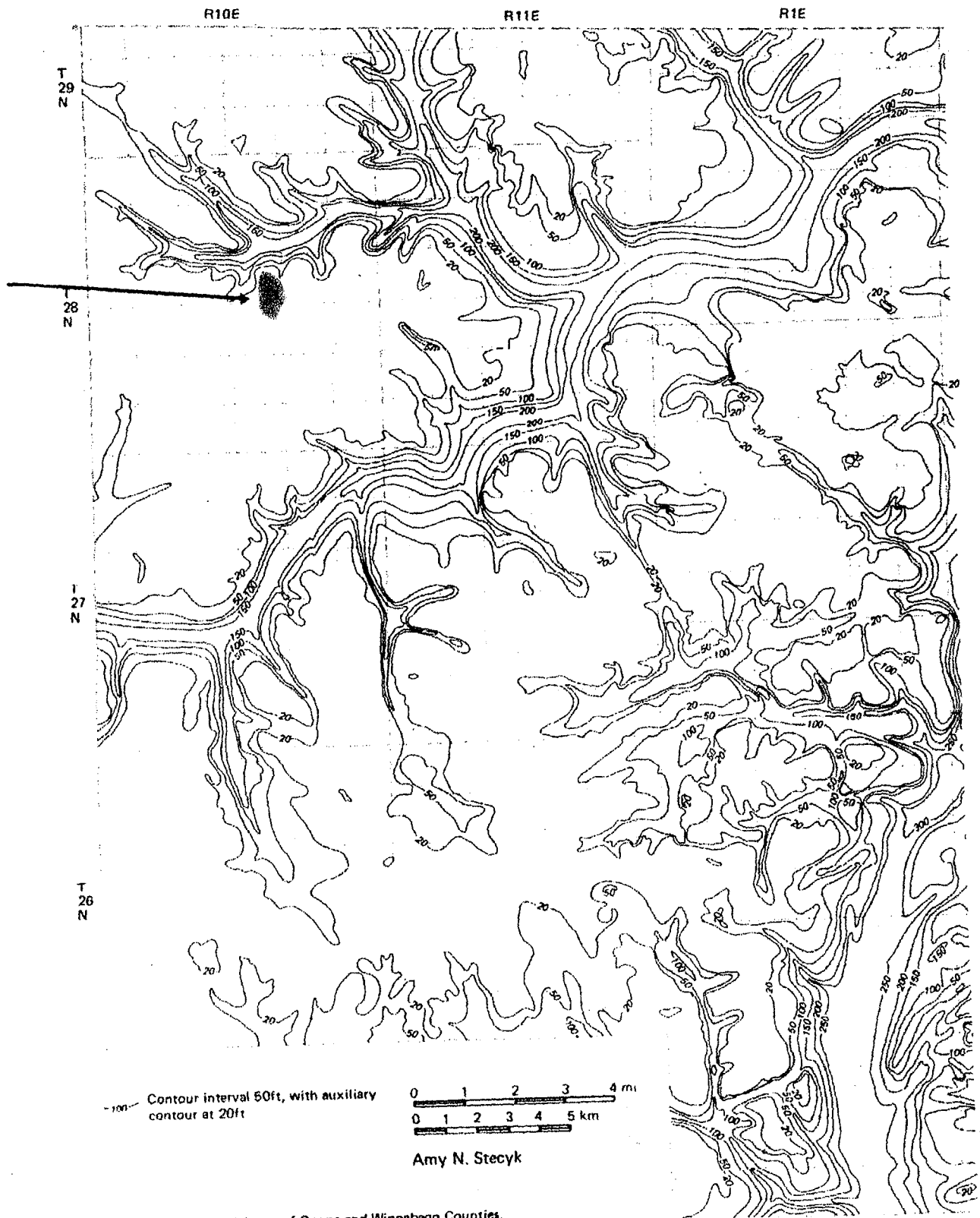

Figure 11. Drift thickness of Boone and Winnebago Counties.

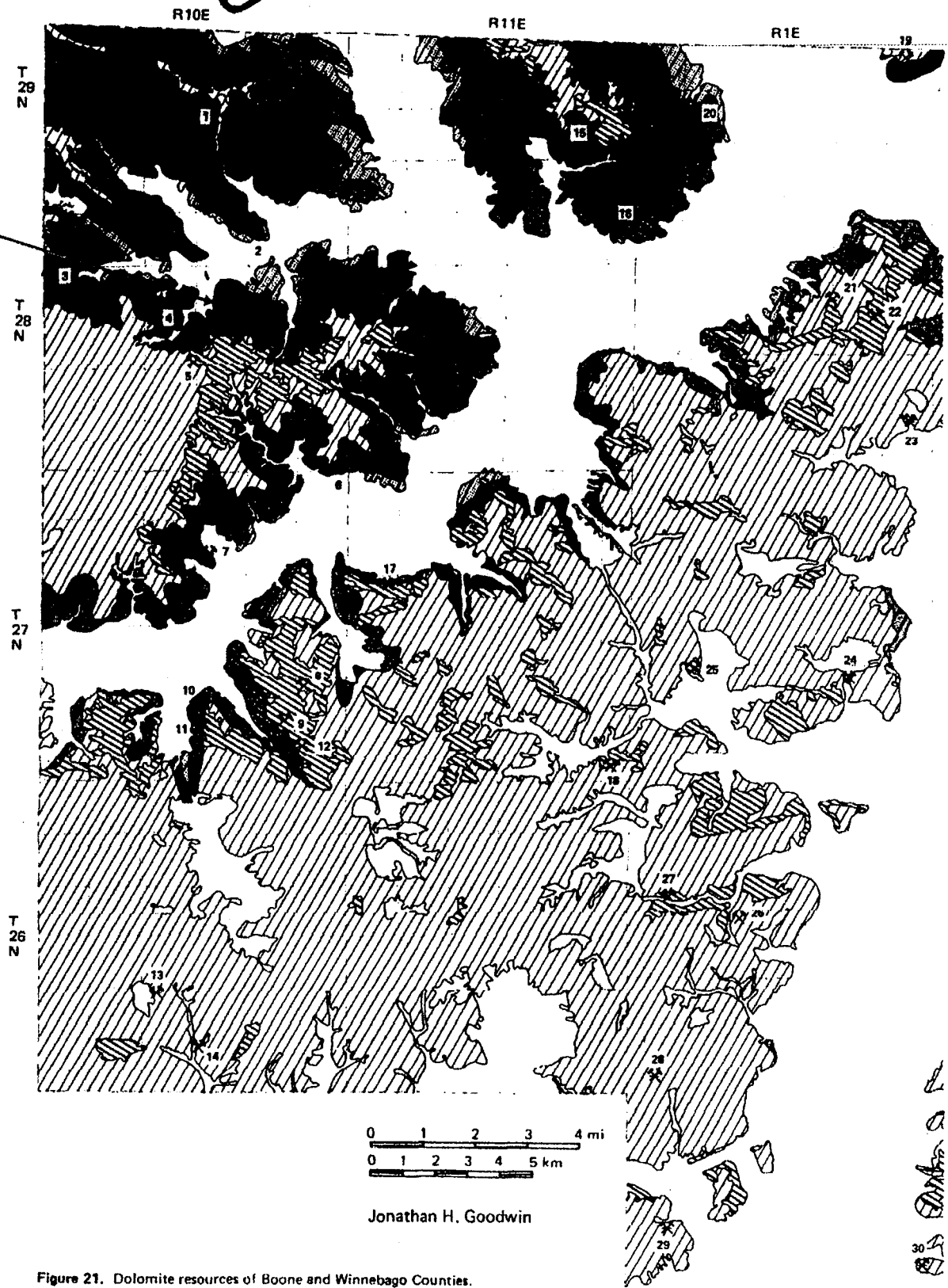

Figure 21. Dolomite resources of Boone and Winnebago Counties.